

# 5.881 Acres LAKE TRAVIS

727 & 801 Indian Mound Road, Spicewood



AirBNB  
Live/Work  
Venue  
Homestead Estate

---

- 1,930 SF Cabin
- 5.881 Acres Waterfront Land
- 2,880 SF Workshop
- 6,300 SF Metal Building
- Lakefront Access & Views
- Private Dock
- Minimal Restrictions
- Septic
- Well
  
- Marble Falls ISD
- Near Spicewood Airport
- On Red Bluff Cove, near Bsrton Creek Lakeside Marina

Tawney Stedman  
Capella Commercial, LLC  
[tawney@capellatx.com](mailto:tawney@capellatx.com)



CAPELLA COMMERCIAL LLC

# 5.881 Acres LAKE TRAVIS



Tawney Stedman  
Capella Commercial, LLC  
[tawney@capellatx.com](mailto:tawney@capellatx.com)  
512-960-6261



# 5.881 Acres LAKE TRAVIS

Nestled on a picturesque 5.88-acre parcel, this stunning property offers breathtaking views and direct access to the crystal-clear waters of Lake Travis. Launch your boat or kayak from your private dock, take a refreshing swim, or spend leisurely afternoons fishing.

The main living area is the heart of the cabin, boasting a vaulted ceiling and large windows that flood the space with natural light. The cabin also features the primary bedroom, two additional loft bedrooms, 1 full bath and 2 - 1/2 baths each providing a comfortable haven for family and guests.

This versatile property is not only a peaceful retreat but also presents an incredible opportunity for various uses. With its lakefront location, stunning views, and ample space, it's an ideal investment for Airbnb rentals, a picturesque venue for special occasions, a live-work setup, or even a serene estate homestead.

For Airbnb rentals, this cabin on Lake Travis is a true gem. The lakefront setting, coupled with the charming and well-appointed interior, will attract guests seeking a Lake Travis getaway. The property's direct access to the lake and the surrounding outdoor activities make it an irresistible destination for nature enthusiasts and water lovers. Enjoy the flexibility of renting out the entire property or individual structures to maximize returns and cater to a wide range of guests. The property offers expansive space to develop additional structures and/or renovate the metal buildings into barndominiums.

Entrepreneurs and business owners will appreciate the live-work potential this property offers. The large metal building and workshop offers storage, garage, or creative studio.

If you've always dreamed of creating your own estate homestead, this property is an idyllic canvas. With its expansive acreage, you have the freedom to develop additional structures or cultivate gardens, creating a self-sustaining oasis. Grow your own fruits and vegetables, raise chickens for fresh eggs, or embark on any other agricultural endeavors that align with your vision. Live a truly sustainable lifestyle while enjoying the comforts and natural beauty that this property affords.



# 5.881 Acres LAKE TRAVIS

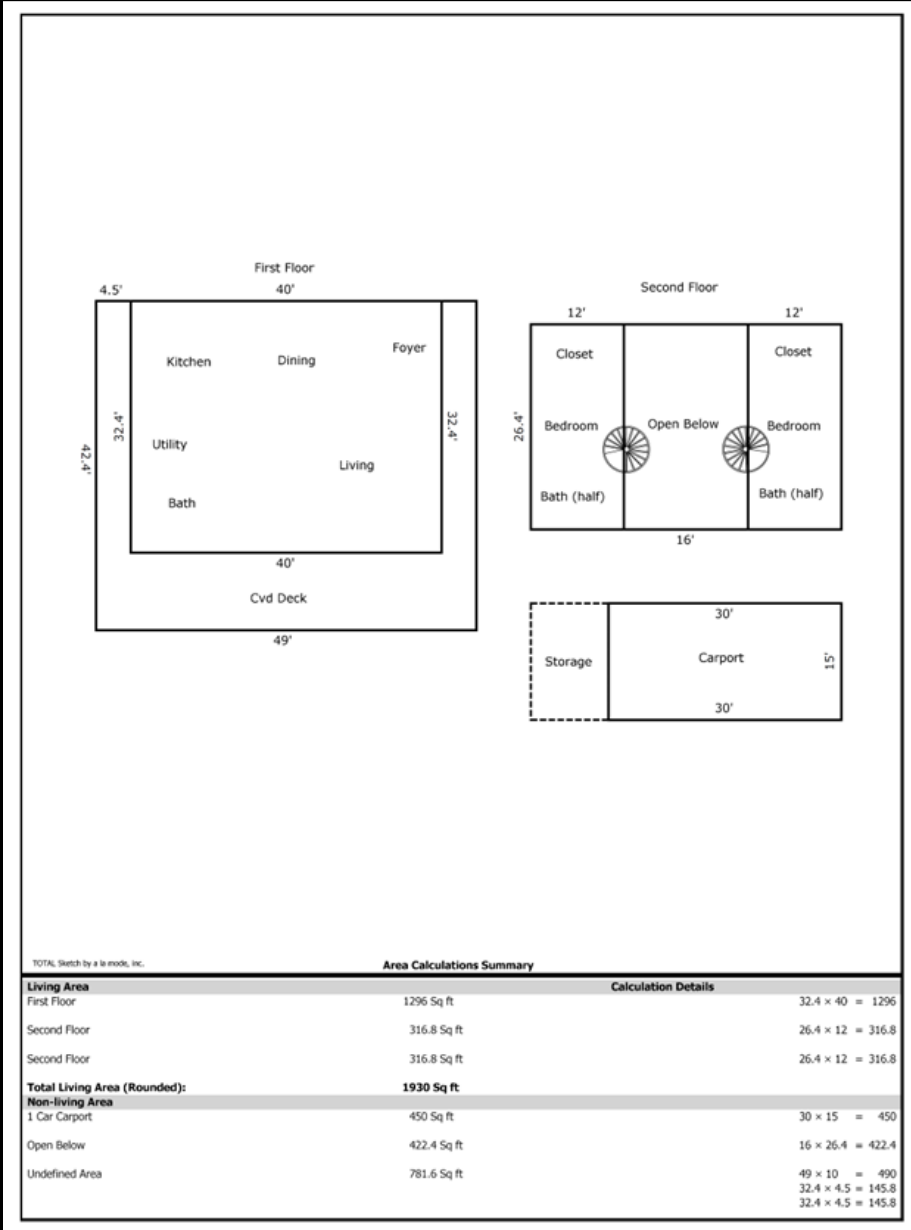

1,696 SF Cabin

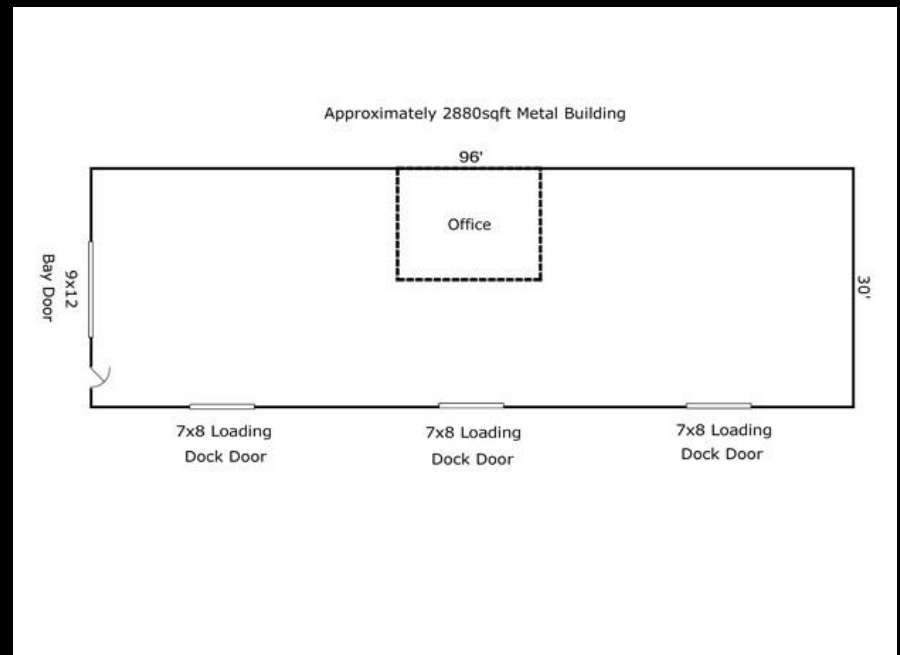

2,880 SF Workshop